

# End Power Feed

700MOPEND\_ 1.8



## GENERAL PRODUCT INFORMATION:



This product is suitable for indoor dry locations only.

This product must be used with Tech Lighting MonoRail system only.

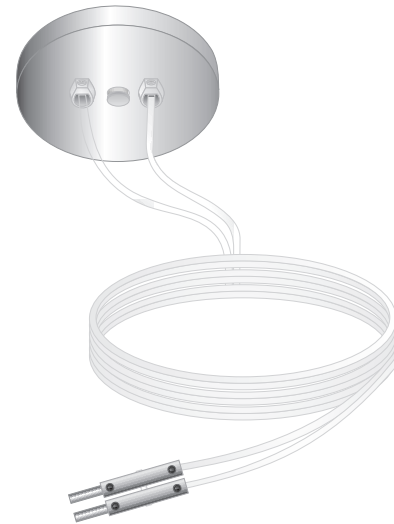

## Connect the End Power Feed Wires Directly to the Remote Transformer

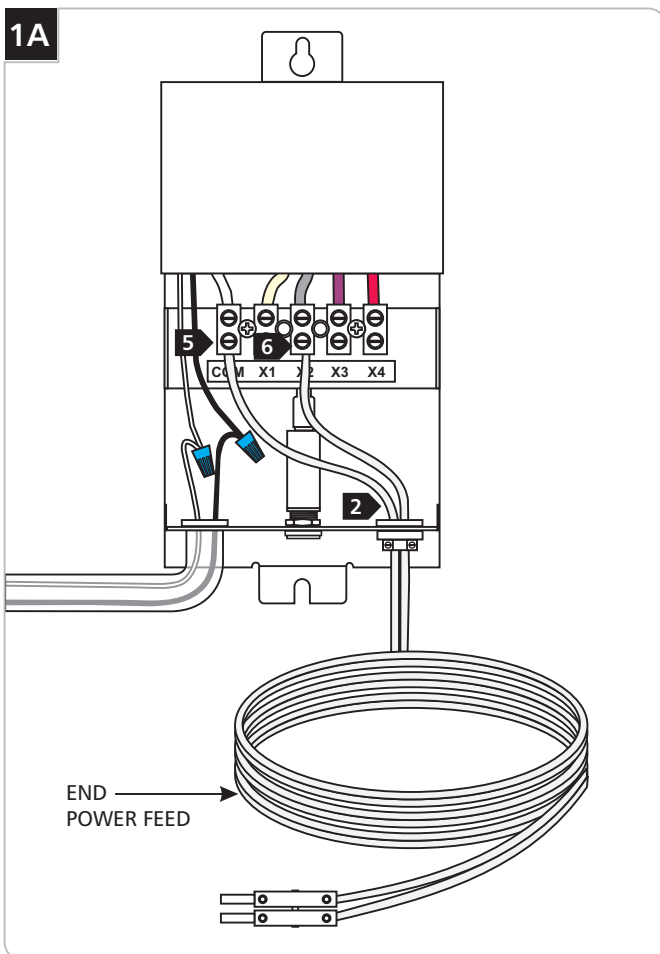

**NOTE:** The provided power feed canopy is not used in this procedure.

- 1 Cut the end power feed wires to the desired length.
- 2 Feed the end power feed wires into the transformer.
- 3 With a sharp knife cut 1" from the end of the wire web and separate the wires 6" from each other.
- 4 Strip 1/2" off the wire ends.
- 5 Connect one end power feed wire to the "COM" terminal.
- 6 Temporary connect the other wire to the terminal marked "X2" (default). After installing the system completely, refer to the remote transformer instructions for reconnecting this wire to the proper terminal "X1-X4".

## Connecting the End Power Feed Wires Directly to the Kable Lite Surface Transformer

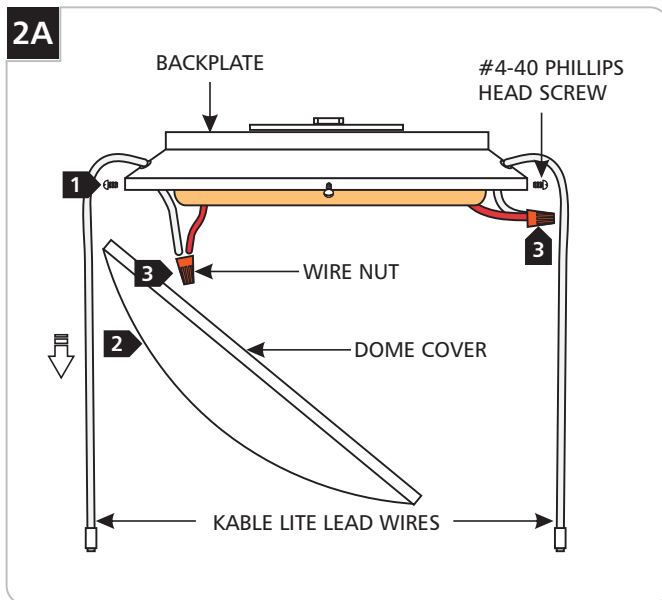

**NOTE:** The provided power feed canopy is not used in this procedure.

- 1** On side of the transformer canopy dome cover, remove the #4-40 Phillips head screws.
- 2** Lift the dome cover off of the transformer backplate.
- 3** Remove the Kable Lite lead wires by removing the wire nut connections.

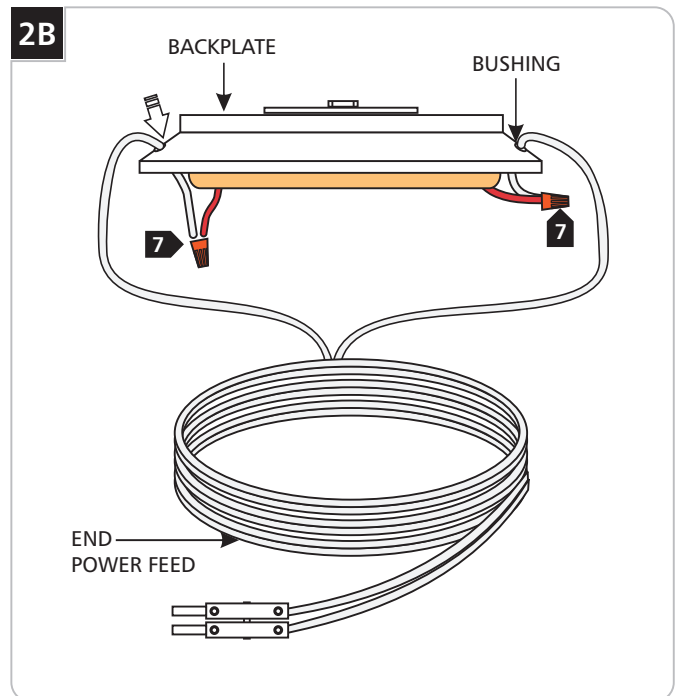

- 4** Cut the end power feed wires to the desired length.
- 5** With a sharp knife cut 1" from the end of the wire web and separate the wires 12" from each other.
- 6** Strip 1/2" off the wire ends.
- 7** Feed the end power feed wires through the backplate bushings and connect them to the loose Low voltage wires with the wire nuts.
- 8** Refer to the Kable Lite surface mount transformer instruction to complete mounting the transformer.

## Install the End Power Feed

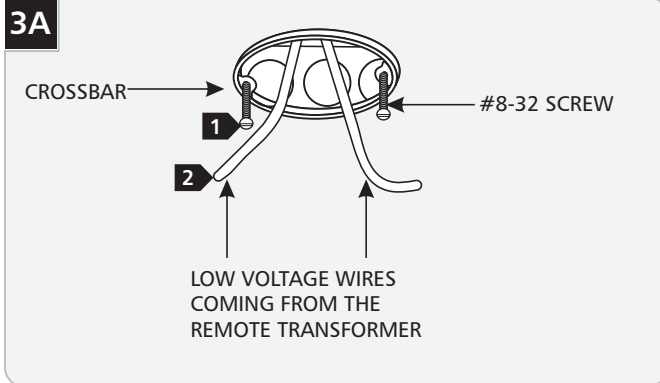

**NOTE:** Low voltage wires must be present in electrical box before proceeding with these steps. Refer to the instructions provided with the remote transformer.

- 1 Mount the crossbar to the electrical box with the provided two #8-32 screws.
- 2 Pull the low voltage wires out of electrical box for power connection.

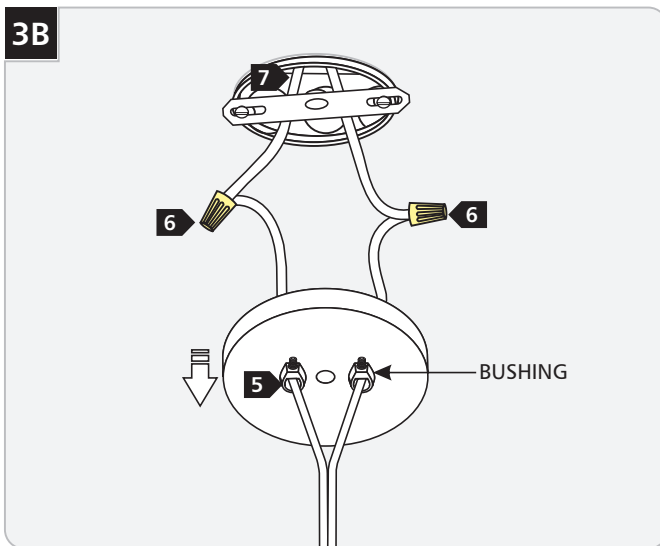

- 3 Cut the end power feed wires to the desired length.
- 4 With a sharp knife cut 1" from the end of the wire web and separate the wires 8" from each other.
- 5 Push the power feed wires through the canopy bushings and slide the canopy down the wires.
- 6 Strip 1/2" off the wire ends and connect them to the electrical box low voltage wires with the provided wire nuts.
- 7 Place the wire nut connections into the electrical box.

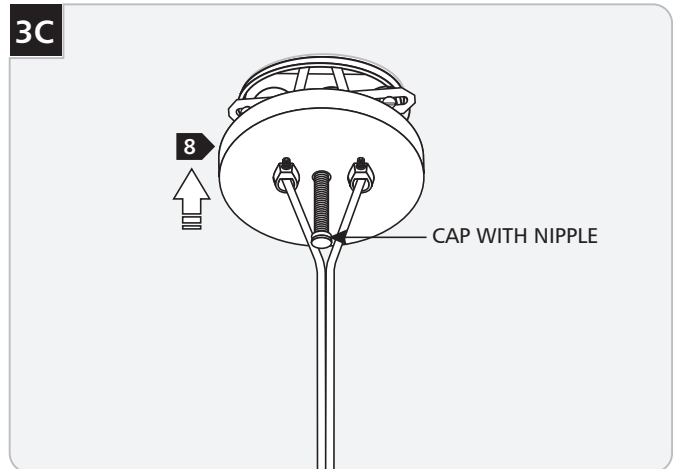

- 8 Slide the canopy up and secure it to the electrical box by screwing the cap with nipple to the crossbar.

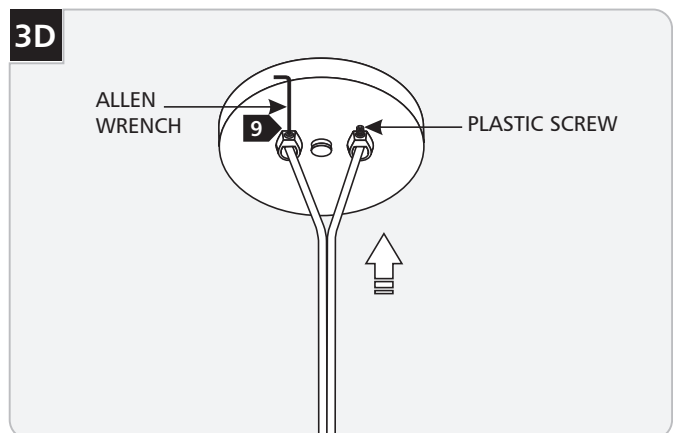

- 9 Push the excess power feed wires into the canopy and tighten the plastic screw with the provided Allen wrench.

## Connecting the End Power Feed Connectors to the MonoRail

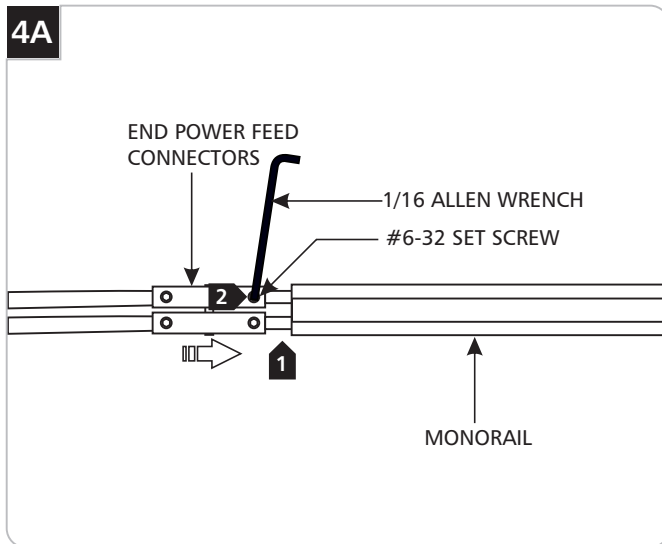

- 1 Insert the end power feed connectors completely into the MonoRail end.
- 2 Tighten the #6-32 set screws with the 1/16 Allen wrench.

**SAVE THESE INSTRUCTIONS!**



**TECH LIGHTING®**

7400 Linder Ave, Skokie, IL 60077

847.410.4400

[www.techlighting.com](http://www.techlighting.com)

© 2008 Tech Lighting, L.L.C. All rights reserved. The "Tech Lighting" graphic is a registered trademark of Tech Lighting, L.L.C. Tech Lighting reserves the right to change specifications for product improvements without notification.

A Generation Brands Company