

PRODUCT FEATURES

- Inspired by Mid-Century modern art, the Orbel flush mount features a circular canopy that supports alternating metal squares and four frosted spheres of light
- 15" diameter and available in three modern finishes, aged brass, matte black and polished nickel
- Ceiling mount only
- Complete the look with other fixtures in the Orbel family, such as the wall sconce, bath light and pyramid or round pendants
- Lamping options are compatible with most dimmers
- Protected by a 1-year warranty. please visit the "About Us" Page on techlighting.com for more for warranty details



LAMPING

Rated for (4) 5W max. G9 bi-pin lamps (Not Included) LED. (4) 120 volt 5 watt (20 total watts) 1212 total delivered lumens, 3000K LED module. Dimmable with most LED compatible ELV and TRIAC dimmers. Ceiling mount only.

Brass
(Aged Brass not shown)



Brass
(Aged Brass not shown)

Polished Nickel

Matte Black

ORDERING INFORMATION

700FMOBL FINISH	LAMP
R AGED BRASS	NO LAMP
B MATTE BLACK	-LED930 BI-PIN G9 LED 90 CRI 3000K 120V (T20/T24)
N POLISHED NICKEL	

700FMOBL _____

JOB NAME _____

NOTES _____



ORBEL CEILING



SPECIFICATIONS

HARDWARE MATERIAL	Metal
SHADE MATERIAL	Glass
NET WEIGHT	13 lbs
HEIGHT	6.3in
WIDTH	15in
LENGTH	15in
UP LIGHT / DOWN LIGHT / BOTH?	
WET LISTED	
DAMP LISTED	Yes
DRY LISTED	
WALL / CEILING MOUNT	
SLOPED CEILING ADAPTABLE?	No
GENERAL LISTING	ETL Listed
INCLUDES	

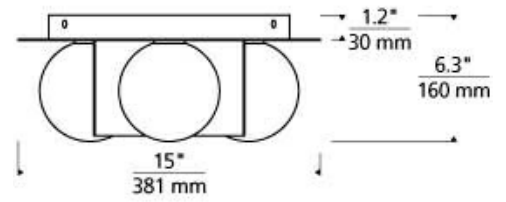

LAMPING SPECIFICATIONS

	LED LAMP	INTEGRATED LED	NON LED	NO LAMP
DELIVERED LUMENS	1212			
WATTS	5			
MAX WATTAGE PER BULB	5W			5W
INPUT VOLTAGE	120V			120V
DIMMING TYPE*	ELV, TRIAC			ELV, TRIAC
CCT	3000K			
CRI	90 CRI			
LED LIFETIME				
L70				
AVERAGE BULB HOURS	25000			
FIELD SERVICEABLE LED				
LAMP BASE	LED Bi-Pin			LED Bi-Pin
LAMP SHAPE	G9			G9
LAMP INCLUDED?	Y			N
WARRANTY**	1 Year			1 Year

* Dimming information available at www.techlighting.com/Downloads#dimming
 ** Visit techlighting.com for specific warranty limitations and details.

T20 / T24 INFORMATION

	Integrated LED	Replacement LED Lamp	No Lamp *
This product can be used to comply with California Building Energy Efficiency Standards 2016 Title 24 Part 6.			
This product can be used to comply with California Appliance Efficiency Standards 2016 Title 20 and may be shipped to and sold in California.			

* If a light fixture or component does not include a lamp or light source, it is the responsibility of the customer to select a lamp that meets the T24 and T20 requirements.

