

Simple elegance is taken to a whole new level with the Voto bollard. A minimalist die-cast metal body is topped with a symmetrical reveal cut from a solid piece of optically pure acrylic. Beautiful LED light pours from the bottom of the thick-cut acrylic to provide ample illumination.

High quality LM80-tested LEDs

for consistent long-life performance and color

Outstanding protection against the elements:

- Marine-grade powder coat finishes
- Stainless Steel mounting hardware
- Impact-resistant, UV stabilized frosted acrylic lensing

SPECIFICATIONS

DELIVERED LUMENS	683.1
WATTS	14.9
VOLTAGE	Universal 120-277V, with integral transient 2.5kV surge protection (driver)
SECONDARY SURGE PROTECTOR	10kA
DIMMING	0-10, ELV
LIGHT DISTRIBUTION	Symmetric Downlight
MOUNTING OPTIONS**	Bolt
PERFORMANCE OPTIONS	Photocontrol / In-Line Fuse
CCT	3000K or 4000K
CRI	80+
COLOR BINNING	3 Step
BUG RATING	B0-U2-G1
DARK SKY	Compliant (Downlight)
WET LISTED	IP65
GENERAL LISTING	ETL, Title 24
START TEMP	-30°C
FIELD SERVICEABLE LED	Yes
CONSTRUCTION	Aluminum
HARDWARE	Stainless Steel
FINISH	Marine Grade Powder Coat
LED LIFETIME	L70; 70,000 Hours
WARRANTY*	5 Years

* Visit techlighting.com for specific warranty limitations and details.

**Bollard base not suitable for branch circuit through wiring.



VOTO BOLLARD
shown in bronze



VOTO BOLLARD
shown in charcoal

ORDERING INFORMATION

7000BVOT	CRI/CCT	LENGTH	LENS	FINISH	VOLTAGE	DISTRIBUTION	OPTIONS
830	80 CRI, 3000K	42 42"	D DIFFUSE	Z BRONZE	UNV 120V-277V	S SYMMETRIC	NONE
840	80 CRI, 4000K			H CHARCOAL			PC BUTTON PHOTOCONTROL
							LF IN-LINE FUSE
							PCLF BUTTON PHOTOCONTROL & IN-LINE FUSE

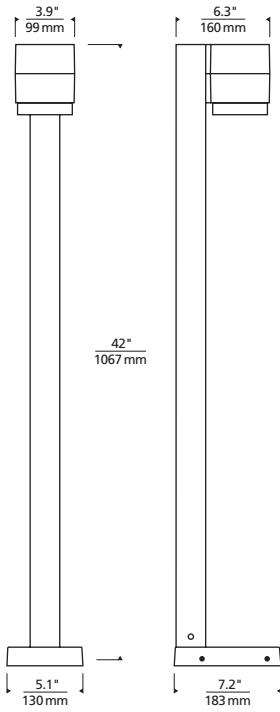

Voto Bollard

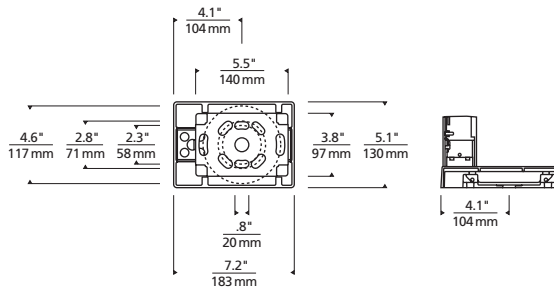

Anchor Plate Bolt Pattern

PHOTOMETRICS*

*For latest photometrics, please visit www.techlighting.com/OUTDOOR

VOTO BOLLARD

Total Lumen Output: 683.1
 Total Power: 14.9
 Luminaire Efficacy: 45.5
 Color Temp: 4000K
 CRI: 80+
 BUG Rating: BO-U2-G1

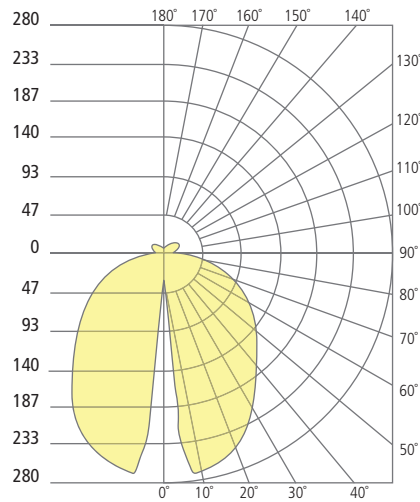

PROJECT INFO

FIXTURE TYPE & QUANTITY	JOB NAME & INFO	NOTES