

# Refuge Small Round and Square Wall

**700WSRFGRS, 700WSRFGSS** 1.0



## GENERAL PRODUCT INFORMATION:

These fixtures are intended to be installed utilizing NEC compliant junction boxes.



This product is suitable for wet locations.

This product can be dimmed with a low-voltage electronic dimmer.

This instruction shows a typical installation.

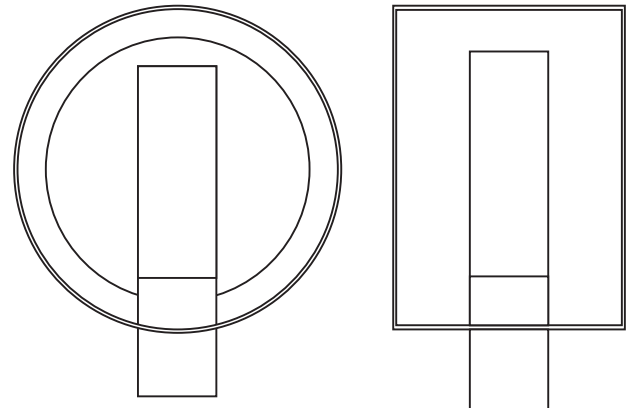

**CAUTION - RISK OF FIRE**  
 This product must be installed in accordance with the applicable installation code by a person familiar with the construction and operation of the product and the hazards involved.  
 Use minimum 90°C supply conductors.

## Install the Fixture

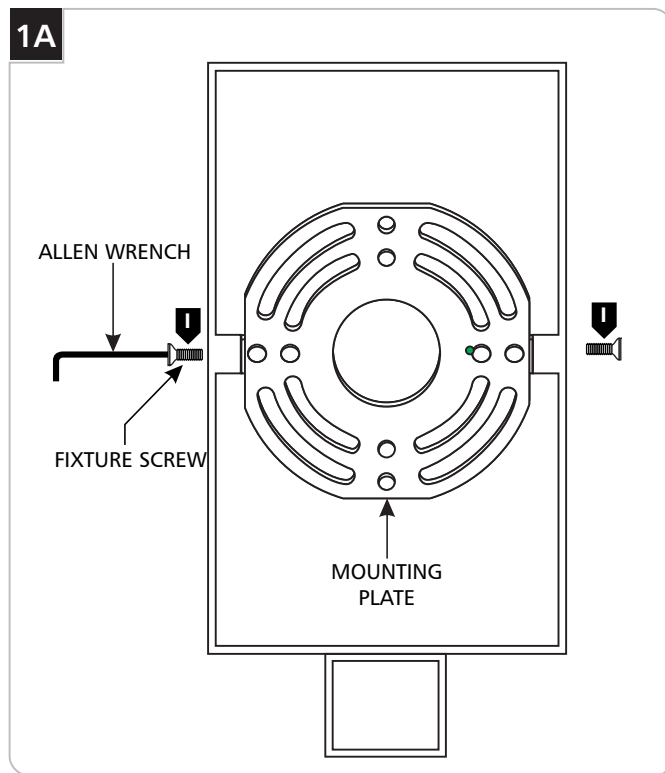

- 1** Remove the fixture screws located on both sides of the fixture base with the provided Allen wrench.
- 2** Remove the mounting plate from the fixture base.

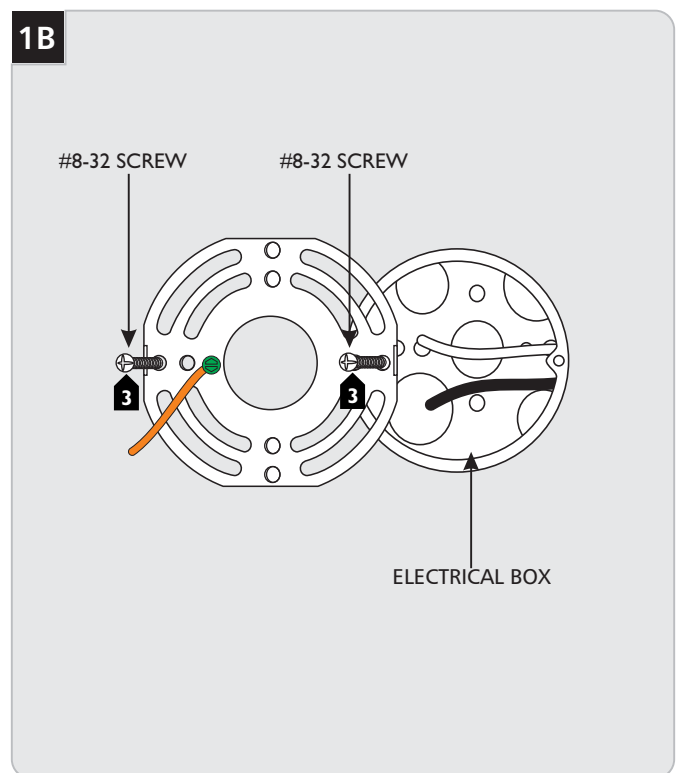

- 3** Install the mounting plate onto the electrical box with the two #8-32 screws provided.

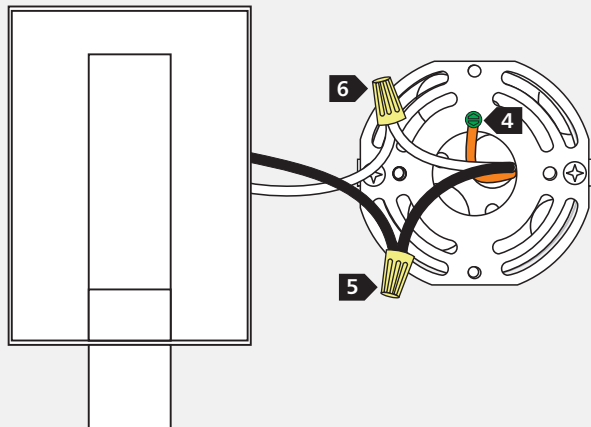
**1C**

- 4** Connect the mounting plate ground wire to a suitable ground in accordance with local electrical codes.
- 5** Connect the black fixture wire to the hot power line wire with a wire nut.
- 6** Connect the white fixture wire to the neutral power line wire with a wire nut.
- 7** Properly place all wires and wire nut connections into the electrical box.
- 8** Mount the fixture by sliding it back onto the mounting plate and reinstalling the fixture screws (reversal of figure 1A).

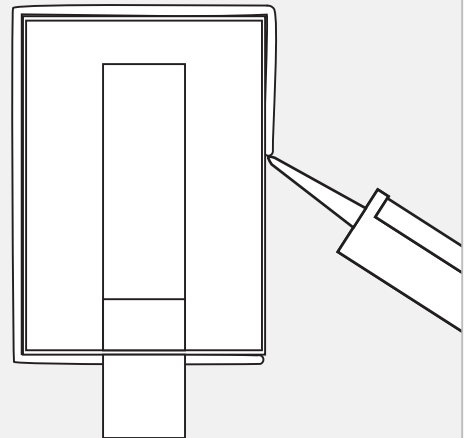
**1D**

- 9** For wet locations, caulk around the base with waterproof construction sealant.

**SAVE THESE INSTRUCTIONS!**



**TECH LIGHTING®**

7400 Linder Ave, Skokie, IL 60077

847.410.4400

[www.techlighting.com](http://www.techlighting.com)

© 2017 Tech Lighting, L.L.C. All rights reserved. The "Tech Lighting" graphic is a registered trademark of Tech Lighting, L.L.C. Tech Lighting reserves the right to change specifications for product improvements without notification.

A Generation Brands Company